

# SABERTOOTH





## SUPER KELLY HOSE

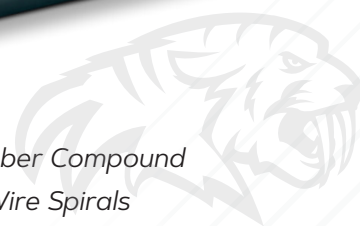

**TUBE**  
**REINFORCEMENT**  
**COVER**  
**TEMPERATURE**  
**SAFETY FACTOR**

*Blend of Synthetic Rubber Compound*  
*Six High Tensile Steel Wire Spirals*  
*Black Synthetic Rubber Compound*  
*-40°F to +248°F*  
*2:1*



| Part Number          |  I.D.<br>(inch) |  O.D.<br>(inch) |  Working Pressure<br>(PSI) |  Bend Radius<br>(inch) |  Lbs./FT |
|----------------------|--|--|--|---|---|
| AH-2-10K-SUPER KELLY | 2"   | 2.81"  | 10,000 PSI   | 22.8"   | 4.22 Lbs/FT   |

### RECOMMENDED FITTINGS

INTEGRAL  
1502 CRIMP  
FITTINGS

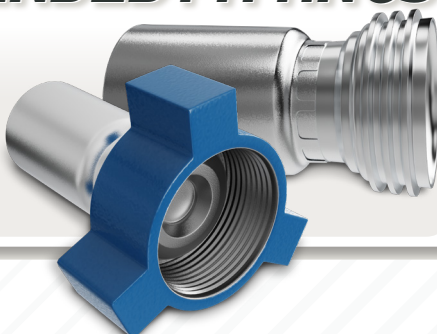

**PROTECT  
YOUR HOSE**



with  
**POLY  
WRAP**

**POWERTRACK** USA

[nationalsales@powertrackhose.com](mailto:nationalsales@powertrackhose.com)